

B4-E-M5-I

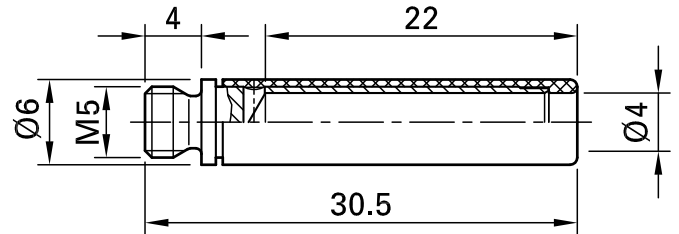

Item number 23.1034-*

Insulated screw-in adapter with M5 external thread for screw connection to threaded holes. Machined brass. Ø 4 mm rigid socket in insulator accepting spring-loaded Ø 4 mm plugs with rigid insulating sleeve. Socket with internal slot for screwdriver.

| Technical data | |
|--------------------------------------|-------------------------|
| Diameter of plug system | 4 mm |
| Rated Values | 30 V, 32 A / 60 V, 32 A |
| Surface treatment electrical contact | Ni |
| Base material electrical contact | CuZn |
| Standard color(s) * | 21 22 23 24 |
| Thread | M5 |
| Test accessory acc. to | IEC EN 61010-031 |
| User-Information | I 098 |